

**LEGEND**

		STORM DRAIN AND MANHOLE
		SANITARY SEWER AND MANHOLE
		SANITARY SEWER FORCE MAIN
		SEWER PUMP STATION
		FIRE HYDRANT AND VALVE ASSEMBLY
		WATER MAIN, VALVE, & BLOWOFF VALVE
		JOINT UTILITY TRENCH
		GAS MAIN
		ELECTRICAL LINE } UG-UNDERGROUND OH-OVERHEAD
		COMMUNICATION LINE "PRIVATE"
		STREET LIGHT CONDUIT, WIRING & PULL BOX
		STREET LIGHT SERVICE POINT AT UTILITY CO. BOX
		STREET LIGHT AND POLE
		UTILITY POLE WITH DOWN GUY & ANCHOR
		POWER POLE, TELEPHONE POLE, JOINT POLE
		FENCE
		VERTICAL CURB, GUTTER & SIDEWALK WITH DRIVEWAY
		CATCH BASIN OR DRAINAGE INLET
		FLOWLINE OF DITCH OR SWALE
		DIRECTION OF SURFACE DRAINAGE FLOW
		CUT OR FILL SLOPE
		RIGHT OF WAY OR PROPERTY LINE
		STREET CENTERLINE OR BASELINE
		SURVEY MONUMENT
		SIGN
		TREE
		TREE TO BE REMOVED
		EXISTING GROUND SURFACE ELEVATION
		EDGE OF PAVEMENT AND ELEVATION
		FLOW LINE GRADE
		TOP OF CURB GRADE/ASPHALT GRADE
		FINISHED CONCRETE GRADE
		EXISTING GRADE/MATCH
		PUBLIC UTILITY EASEMENT
		ROLL CURB, GUTTER, & SIDEWALK

**UTILITY REPRESENTATIVES**

SERVICE	UTILITY	CONTACT	PHONE
GAS	PG&E	LEW BLEVINS	(530) 661-5662
ELECTRICITY	PG&E	LEW BLEVINS	(530) 661-5662
TELEPHONE	AT&T	HEATHER BENDER	(707) 258-5142
CABLE TV	NONE		
USA	EXISTING UNDERGROUND		(800) 227-2600
FIRE	WOODLAND FIRE DEPARTMENT	FIRE MARSHALL	(530) 661-5960
DRAINAGE	YOLO COUNTY	PUBLIC WORKS DEPARTMENT	(530) 666-8775

**BENCH MARKS**

DESIGNATION - CITY BENCH MARK F-14  
 DESCRIPTION:  
 FOUND 1" OPEN IRON PIPE IN MONUMENT WELL 9'± S. OF N. FOG LINE OF KENTUCKY AVE. AND PROJECTION OF CL. OF N. COTTONWOOD ST.  
 ELEVATION = 66.098'  
 DATUM: NAVD 88

# IMPROVEMENT PLANS FOR YOLO COUNTY HEALTH AND HUMAN SERVICES AGENCY PLAYGROUND

134 N. COTTONWOOD STREET, WOODLAND, CA

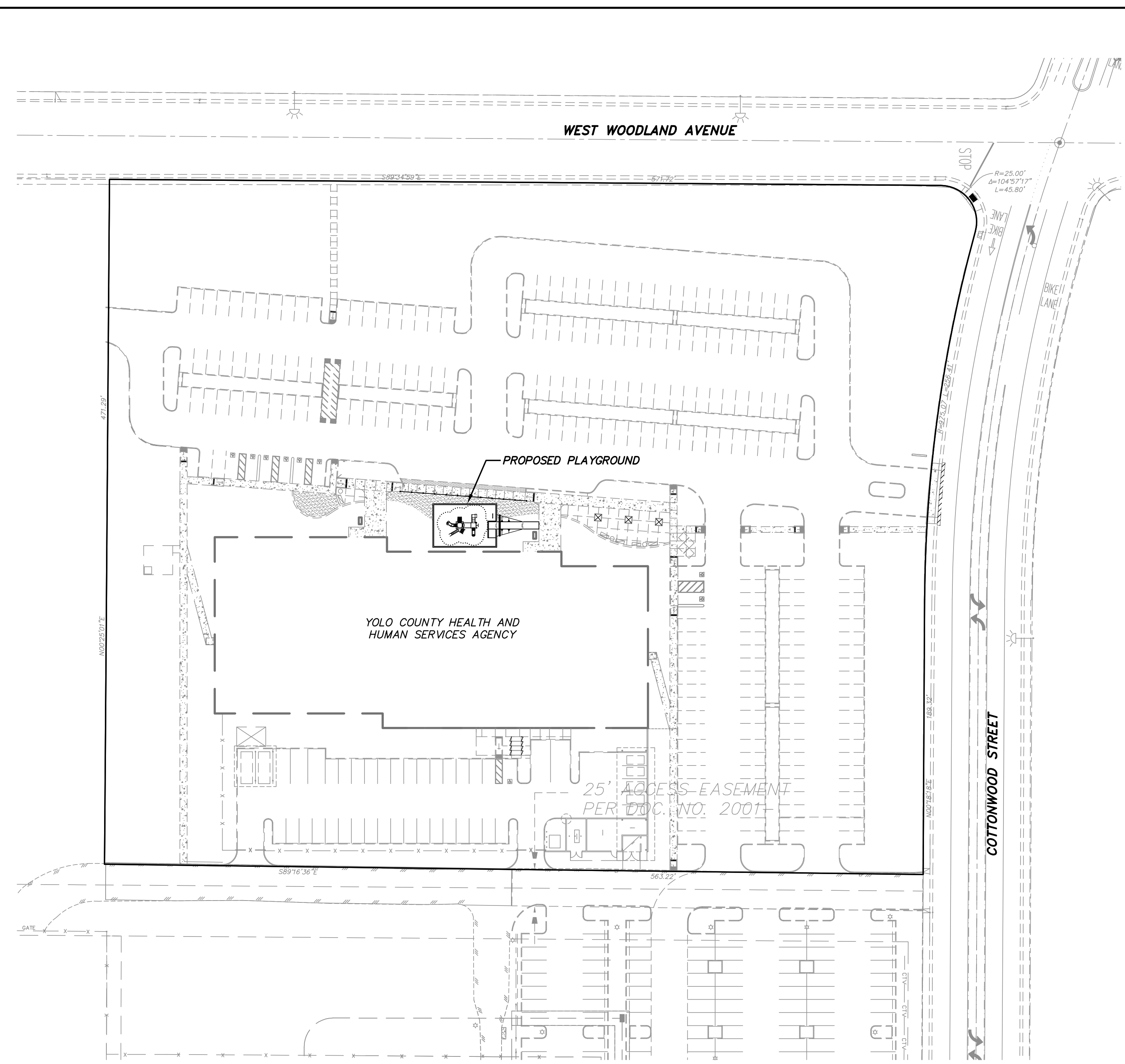

**SITE PLAN**  
NTS

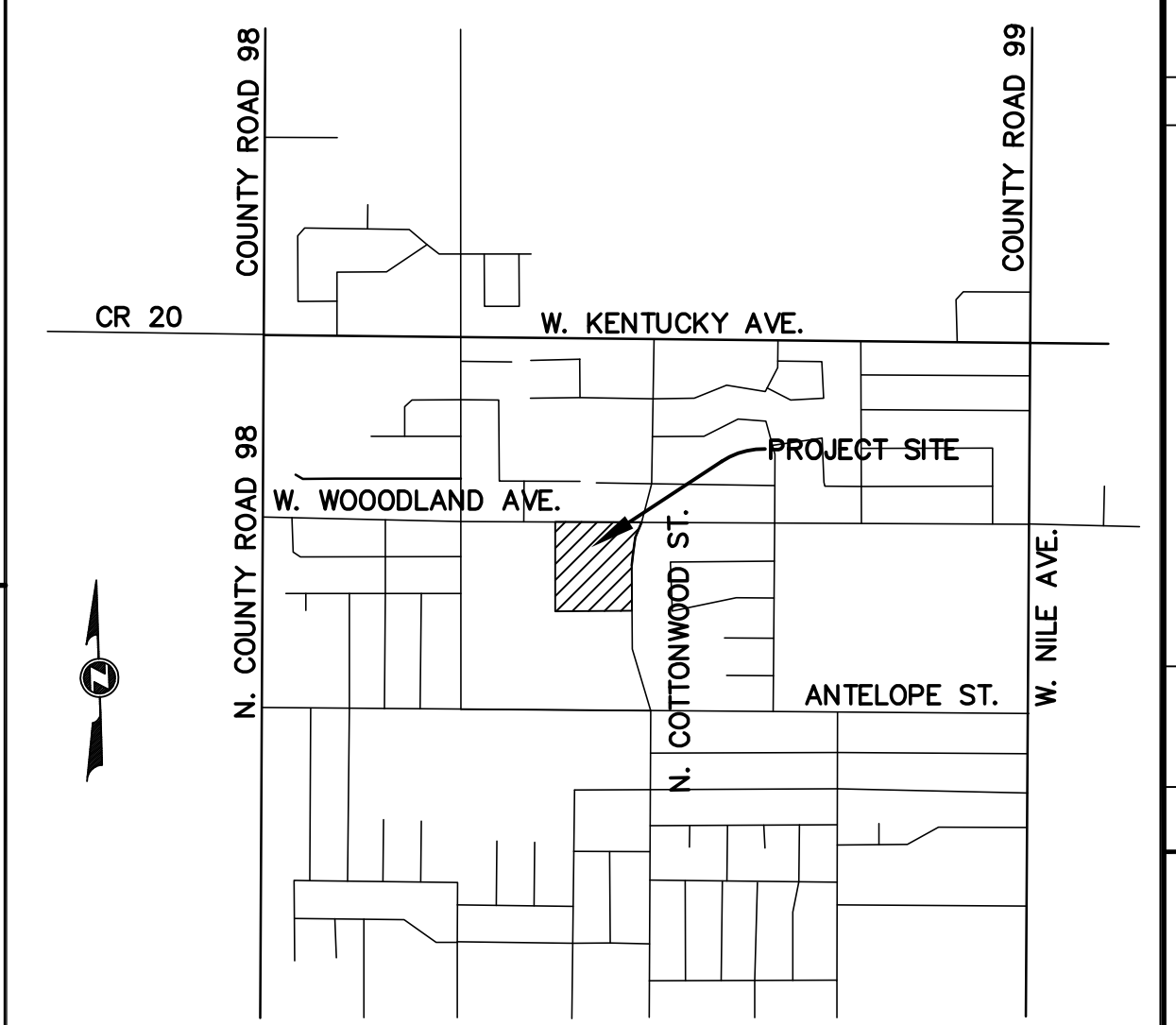
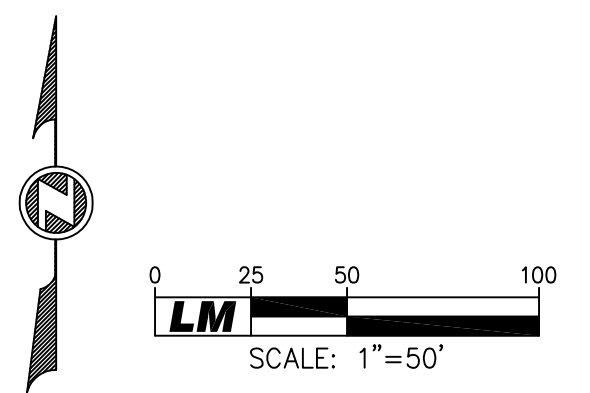

**VICINITY MAP**  
NTS

**SHEET INDEX**

- C-001 TITLE SHEET
- C-002 SITE IMPROVEMENT PLAN

<p><b>LM LAUGENOUR AND MEIKLE</b>                  CIVIL ENGINEERING - LAND SURVEYING - PLANNING                  808 COURT STREET, WOODLAND, CALIFORNIA 95695 - PHONE: (530) 662-1755                  P.O. BOX 828, WOODLAND, CALIFORNIA 95776 - FAX: (530) 662-4602</p>	<p>REGISTERED PROFESSIONAL ENGINEER - CIVIL                  No. 59277                  STATE OF CALIFORNIA</p>
<p>BY: TODD C. TOMMERHAASON                  DATE: P.E. 59277</p>	<p>DESCRIPTION: BY APP'D</p>
<p>IMPROVEMENT PLANS FOR YOLO COUNTY HEALTH AND HUMAN SERVICES AGENCY PLAYGROUND</p>	
<p>CITY OF WOODLAND CALIFORNIA</p>	
<p>TITLE SHEET</p>	
<p>JOB NO. 5000                  FILE                  DESIGNED BY TCT                  DRAWN BY MSW                  CHECKED BY TCT                  DATE 3-13-18                  SCALE 1"=50'</p>	
<p><b>C-001</b></p>	
<p>SHEET 1 OF 2</p>	

X:\Land Projects\5000-2018 EDD Playground\dwg\C001.dwg